

# PRESTLEY MILL MEDICAL BUILDING / FOR LEASE



**404.257.9800**

## *Address:*

**4586 Timber Ridge Drive,  
Douglasville, Georgia 30135**

## *Property Information:*

- ◆ **27,894 SF Building**
- ◆ **13,947 SF - Available  
Summer 2010 (Divisible)**
- ◆ **1,824 SF (4 Exam Suite)**

## *For Information:*

**Tom Kirbo**  
TOMKIRBO@KIRBOPROPERTIES.COM

**Michael H. Brown**  
MBROWN@KIRBOPROPERTIES.COM

## FEATURES

- ◆ **Wellstar Douglas Hospital Market**
- ◆ **Building Signage Available**
- ◆ **Fully built out medical suites**
  - ✓ **1,824 SF (4 Exam Suite)**
  - ✓ **13,947 SF (can be subdivided)**
- ◆ **Perfect for all Practice Specialties:**
  - General Practice**
  - Pediatrics**
  - Dental Specialists**

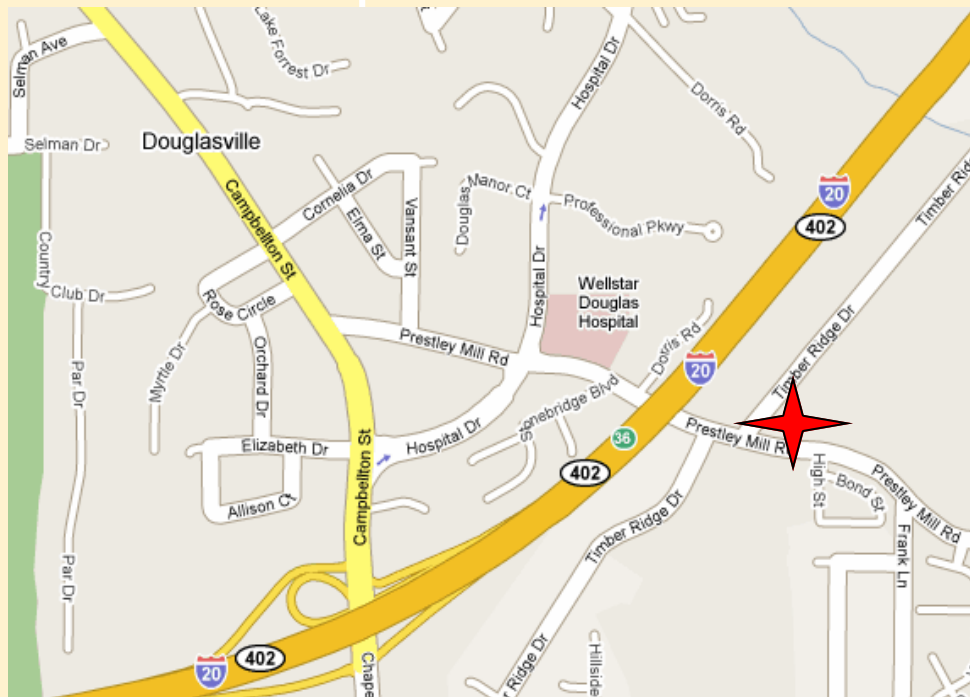

**KIRBO PROPERTY SERVICES, LLC**

REAL ESTATE | BROKERAGE | DEVELOPMENT

*Specializing in Medical Office Real Estate*

[www.kirboproperties.com](http://www.kirboproperties.com)

# AERIAL



## FLOOR PLAN

**SUITE 180 - 1,824 sf**

- ✓ **Fully Built out**
- ✓ **4 Exam Rooms**

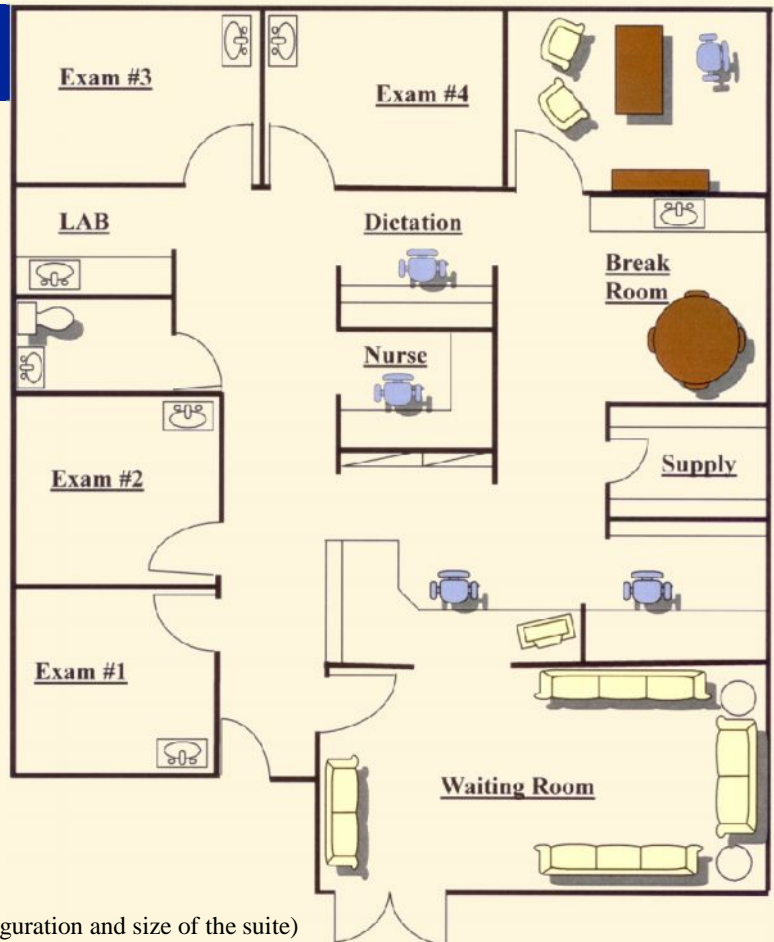

(Floor Plan is for information only and may not reflect the actual configuration and size of the suite)

**KIRBO PROPERTY SERVICES, LLC**  
REAL ESTATE | BROKERAGE | DEVELOPMENT

*Specializing in Medical Office Real Estate*

[www.kirboproperties.com](http://www.kirboproperties.com)